

Scale: N.T.S.

KEY

- ROAD CLOSED AREA
- DIVERSION
- ACCESS ONLY

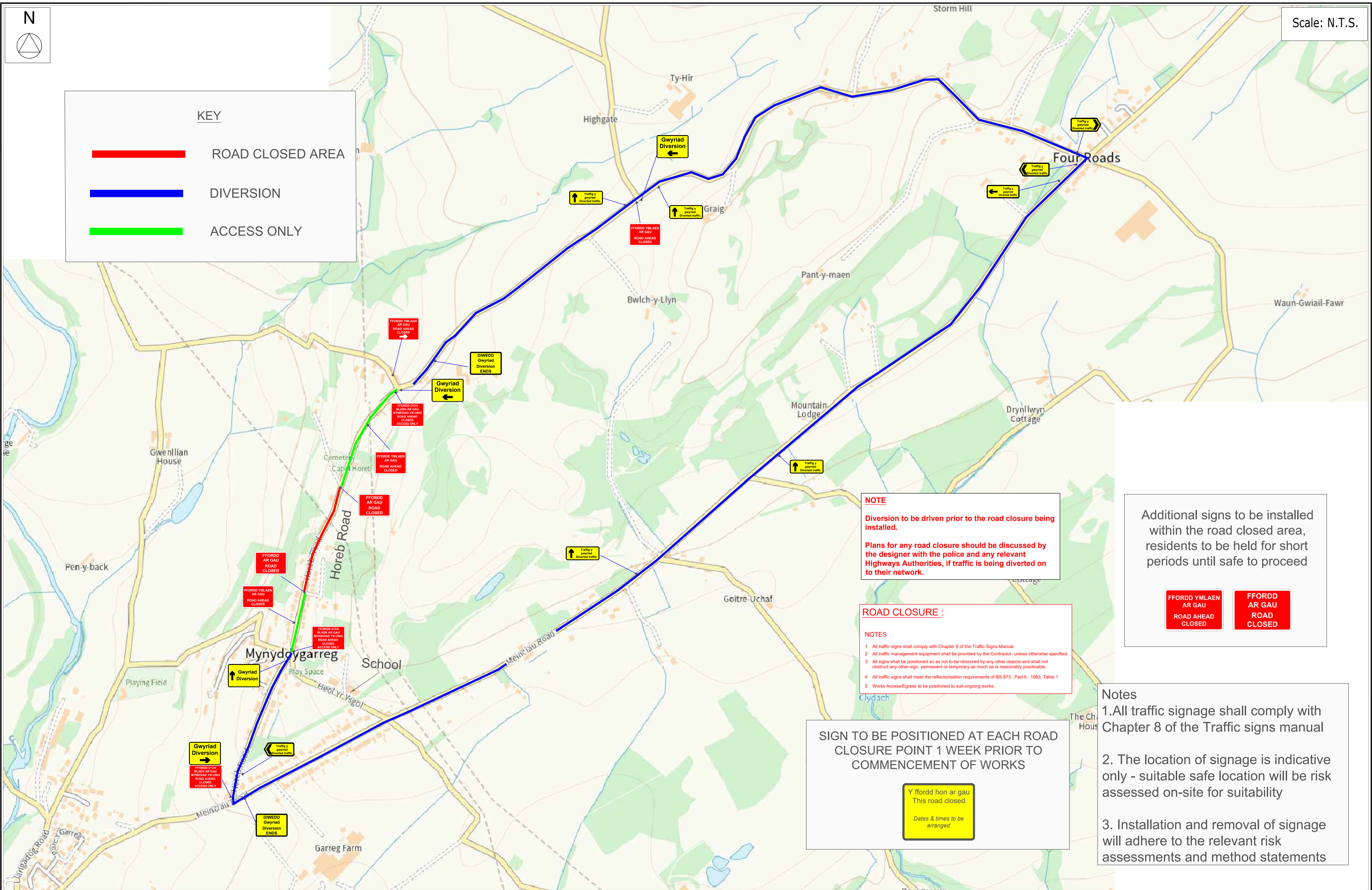

NOTE
 Diversion to be driven prior to the road closure being installed.
 Plans for any road closure should be discussed by the designer with the police and any relevant Highways Authorities, if traffic is being diverted on to their network.

Additional signs to be installed within the road closed area, residents to be held for short periods until safe to proceed

- ROAD CLOSURE :**
- NOTES**
- 1 All traffic signs shall comply with Chapter 8 of the Traffic Signs Manual
 - 2 All traffic management equipment shall be provided by the Contractor, unless otherwise specified.
 - 3 All signs shall be positioned so as not to be obscured by any other objects and shall not obstruct any other sign, permanent or temporary as much as is reasonably practicable.
 - 4 All traffic signs shall meet the reflectorisation requirements of BS 873 - Part 6 : 1983, Table 1.
 - 5 Works Access/Egress to be positioned to suit ongoing works.

SIGN TO BE POSITIONED AT EACH ROAD CLOSURE POINT 1 WEEK PRIOR TO COMMENCEMENT OF WORKS

- Notes**
1. All traffic signage shall comply with Chapter 8 of the Traffic signs manual
 2. The location of signage is indicative only - suitable safe location will be risk assessed on-site for suitability
 3. Installation and removal of signage will adhere to the relevant risk assessments and method statements

	Drn:	ORS	Client: M.J QUINN ONSA	Project: Clear 2 x blockages	Rev	Drn	Chk	APP	Description	Date	TM TYPE:	Road closure of Horeb Road diversion	Ref:	67-1900-MJQ2025-1236 - WG5GVC2D - KIDWELLY - 51-1000-TMA01	
	Chk:	SP											Address:	Horeb Road, Four Roads, Kidwelly, Meinciau, Carmarthenshire, Wales, SA17 4NG, United Kingdom	
	REV:														
	Date:	26/02/25													GRID X-242775 , Y-208331